



Series 50 TQC Tube Quick-Connect Coupler For 3/16", 1/4", 5/16" and 3/8" O.D. Tubes

FEATURES

- Leak-Free, Positive Locking
- Quick Connect Disconnect
- Valved Shutoff
- Adaptability
- 1" Straight Tube Length

APPLICATIONS

- Refrigerants
- Vacuum/Air
- Oil
- Water
- Mass Spectrometer Applications
- Helium
- Nitrogen



These tough, compact, lightweight PCU couplers utilize heat-treated parts for interchangeability and long life, oxide and nickel finishes resist corrosion. They provide a large, unrestricted flow rate for a variety of production uses, while minimizing process material loss during coupling/uncoupling, in a temperature range of 0° to 250° F.

For a valved coupler, the "TQC" Coupler is shown with our Series 250 Nipple as an integral assembly.

The Production Control Units Series 50 "TQC" is designed for easy installation onto the end of straight tubing. Slide the coupler onto the tubing until seated and push down on the mechanical lock (lever) to make a positive seal. A cam-locking device grips uniformly-firmly but gently-without damage to steel, copper, brass or plastic tubing.

The tube seal will accept tubing out-of-roundness conditions up to 2%. Long-life seal reduces connector maintenance costs.

STRONG-Holds pressures from 25 microns up to 500 psig, minimum proof pressure 4000 psig.

SAFE-Built-in valve automatically vents system pressure before the connector can be removed from the tube for operator safety. Blow-off or loss of seal connection by accidental bumping is eliminated.

FLEXIBLE-Internal parts are quickly interchangeable allowing the same connector body to fit all four tube sizes.

When vacuum and ester oils are being used, please contact our Order Department at (1-937-299-5594) for help in selection of the correct elastomer for your particular application.

Series 50 TQC Tube Quick-Connect Coupler Assemblies

Mates with our female Series 250 Two-Way Shutoff Valved Process Coupler.

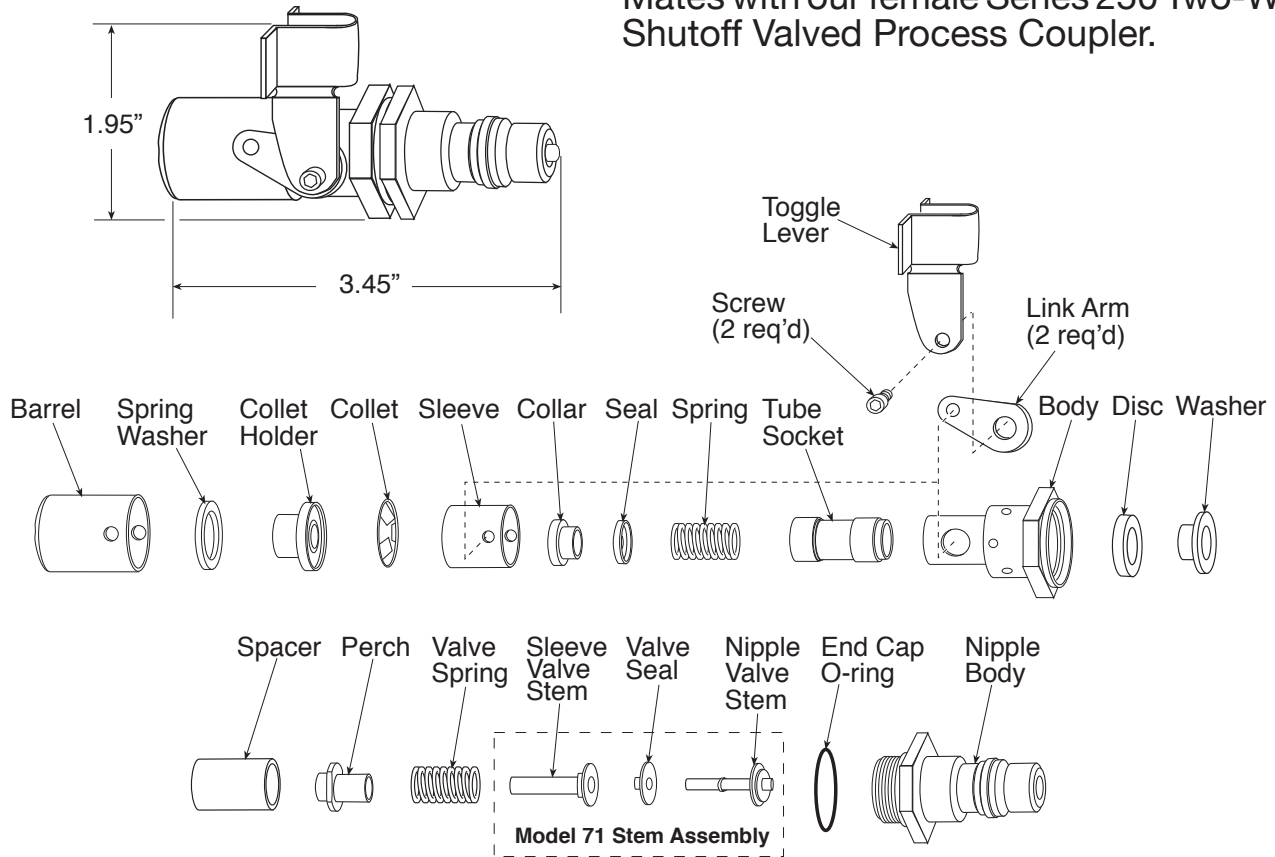

Part Number	50		
Series 50 TQC			
<u>Tube Size</u>	<u>End Cap Size & Style</u>		<u>O-Ring Compounds</u>
3 = 3/16"	1 = 1/4" NPT, female		1 = Neoprene
4 = 1/4"	2 = 1/4" SAE, flare, male		2 = Buna-n (Nitrile)
5 = 5/16"	3 = 1/4" NPT, male		3 = Fluorocarbon (Viton)
6 = 3/8"	5 = 3/8" NPT, female		6 = EPDM
	6 = Series 250 Nipple, Model 61		7 = For use with HFC-134a refrigerant
	7 = Series 250 Nipple, Model 71		
	8 = 3/8" NPT, male		
	M6 = Series 250 Nipple, Model 64		

* Special end cap adapters available at extra cost.

** Metric sizes available.

SERVICE BULLETIN

Service Bulletin SB50-1 contains general description, spare parts list, and maintenance information.



Production Control Units, Inc.

2280 West Dorothy Lane, Dayton, Ohio 45439-1892 Phone (937) 299-5594 FAX: (937) 299-4843
 ©Production Control Units, Inc. U.S.A. Web: www.pcuinc.com